

# Steel helps protect, enhance



• Artist's impression

**K**IT homes are a way for the homebuyer to achieve the result they want in an economical way, says Jay Saeedi.

Mr Saeedi, the director of 21st Century Steel Homes and Frames, said the shift towards kit homes was being driven by the state of the economy.

"With this in perspective, 21st Century Steel Homes started promoting its old and new designs as full kit-home packages," he said.

"We have the expertise to become a major supplier of any size and style kit home."

The Calypso is one of the company's revamped designs that can be supplied to lock-up stage for \$87,500 plus GST.

"The company is a QBSA-licensed building company and can supply and fix our kit homes based on customer requirements.

"The client needs to organise a concreter, plumber and electricians and we can do the rest to get the project to lock-up stage," said Mr Saeedi.

"To finish the home to meet final expectations, the owner can then hire the necessary tradesmen."

The kit-home package includes architectural plans for council, engineered steel framing, a Colorbond roof system, doors, windows, light concrete CSR Hebel panels or weatherboard as external cladding, internal lining and fit-out materials.

Mr Saeedi said the company was in the process of adding more designs to its portfolio that would suit owner-builders or developers.

"Our frame system is preferred by many customers because it is stronger and suits any design specifications," he said.

"The trusses span up to 15m with-

out any middle support and we can manufacture load-bearing walls up to 6m high."

Mr Saeedi said he invited potential clients to visit the factory or to see frames being built at different sites so they could appreciate the quality of the company's product.

"We do not use rivet systems or any steel less than 1mm thick," he said.

"All our joists are fully welded to achieve maximum strength, which is why our framing system does not move or make any noise from heat expansion."

Customers are encouraged to bring in their own designs when consulting with the company.

The factory is at 24 Mercantile Court, Molendinar.

For details call 5574 4796 or go to [www.steelhomes.com.au](http://www.steelhomes.com.au)



Kit-home packages are a new direction for this builder

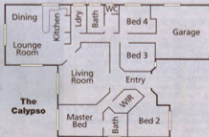

- design**  
The Calypso – kit style
- builder**  
21st Century Steel Homes and Frames
- features**  
251sqm, four bedrooms, master bedroom with ensuite and spa, modern kitchen, large entertaining and living areas
- price**  
\$87,500 plus GST